

**SKINTOP**

Material: PA  
 Farbe: grau/schwarz  
 Dichtung: CR/NBR  
 Zugentlastung: nach EN 62444, Ausf. A\*  
 Einsatztemperatur: statisch -40°C bis 100°C  
 dynamisch -20°C bis 100°C  
 Schutzart: IP 68

Material: PA (nylon)  
 Colour: grey/black  
 Sealing insert: CR/NBR  
 Strain relief: acc. to EN 62444, version A\*  
 Temperature range: static -40°C to 100°C  
 dynamic -20°C to 100°C  
 Protection type: IP 68

**183.00**  
**183.01**

\* nur metrische Größen

\* only metric sizes

Weitere internationale Zulassungen vorhanden

Further international approvals available



Gewinde Entry Thread AG	$\varnothing k$ mm	$\varnothing M$ mm	H mm	GL mm	grau/grey RAL 7001 HUGRO No.	schwarz/black RAL 9005 HUGRO No.
M 12 x 1,5	1 - 5	15	22	8	183.1505	183.1505.01
M 12 x 1,5	3,5 - 7	15	22	8	183.1507	183.1507.01
M 16 x 1,5	2 - 7	19	26	8	183.1707	183.1707.01
M 16 x 1,5	4,5 - 10	19	26	8	183.1710	183.1710.01
M 20 x 1,5	5 - 10	25	28	9	183.2010	183.2010.01
M 20 x 1,5	7 - 13	25	28	9	183.2013	183.2013.01
M 25 x 1,5	6 - 13	30	30	10	183.2513	183.2513.01
M 25 x 1,5	9 - 17	30	30	10	183.2517	183.2517.01
M 32 x 1,5	7 - 15	36	37	10	183.3215	183.3215.01
M 32 x 1,5	11 - 21	36	37	10	183.3221	183.3221.01
M 40 x 1,5	15 - 23	46	42	10	183.4023	183.4023.01
M 40 x 1,5	19 - 28	46	42	10	183.4028	183.4028.01
M 50 x 1,5	22 - 29	55	50	12	183.5029	183.5029.01
M 50 x 1,5	27 - 35	55	50	12	183.5035	183.5035.01
M 63 x 1,5	28 - 39	66	59	12	183.6339	183.6339.01
M 63 x 1,5	34 - 45	66	59	12	183.6345	183.6345.01
Pg 7	1,5 - 5	15	24	8	183.0705	183.0705.01
Pg 7	2,5 - 6,5	15	24	8	183.0707	183.0707.01
Pg 9	2 - 6	19	28	8	183.0906	183.0906.01
Pg 9	3,5 - 8	19	28	8	183.0908	183.0908.01
Pg 11	2 - 7	22	30	8	183.1107	183.1107.01
Pg 11	4 - 10	22	30	8	183.1110	183.1110.01
Pg 13,5	4 - 9	24	32	9	183.1309	183.1309.01
Pg 13,5	6 - 12	24	32	9	183.1312	183.1312.01
Pg 16	6 - 12	27	34	10	183.1612	183.1612.01
Pg 16	9 - 14	27	34	10	183.1614	183.1614.01
Pg 21	9 - 16	33	38	11	183.2116	183.2116.01
Pg 21	13 - 18	33	38	11	183.2118	183.2118.01
Pg 29	11 - 20	42	45	11	183.2920	183.2920.01
Pg 29	14 - 25	42	45	11	183.2925	183.2925.01
Pg 36	17 - 26	53	53	13	183.3626	183.3626.01
Pg 36	24 - 32	53	53	13	183.3632	183.3632.01
Pg 42	22 - 31	60	55	13	183.4231	183.4231.01
Pg 42	35 - 38	60	55	13	183.4238	183.4238.01
Pg 48	26 - 35	65	55	14	183.4835	183.4835.01
Pg 48	39 - 44	65	55	14	183.4844	183.4844.01
3/8" NPT	2 - 6	19	28	15	183.3906	183.3906.01
3/8" NPT	3,5 - 8	19	28	15	183.3908	183.3908.01
1/2" NPT	4 - 9	24	32	13	183.1909	183.1909.01
1/2" NPT	5 - 12	24	32	13	183.1912	183.1912.01
3/4" NPT	9 - 16	33	38	15	183.3516	183.3516.01
3/4" NPT	13 - 18	33	38	15	183.3518	183.3518.01
1" NPT	19 - 25,4	42	45	15	183.7525	183.7525.01

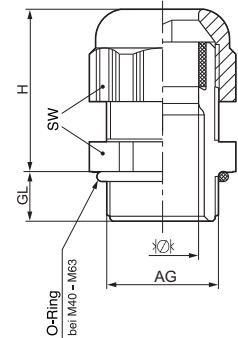

**Auf Anfrage:** - in RAL 7035  
**On request:** - in RAL 7035